

24/1 Rouseabout Street Lawson ACT

2 3 1

Stunning tri level versatile townhouse 2 bed + multi purpose room each with a bathroom, backing onto a beautiful nature reserve

This tri-level townhouse enjoys plenty of space and natural light throughout and offers modern palettes of white and grey with timber hybrid flooring.

On the main level, a stylish open plan kitchen is ideally positioned between the living and dining area and boasts stone bench top/breakfast bar area with a double, stainless steel sink, plenty of cupboard space, pendant lighting, stainless steel gas hotplates, under bench oven and dishwasher.

Type : Townhouse
Price : \$690,000+
Building Size : 130.49 sqm
View : <https://www.bradysrealestate.com.au/sale/act/belconnen/lawson/residential/townhouse/8138621>



Nicola Brady
0421 558 454

[For full version visit the website](https://www.bradysrealestate.com.au)

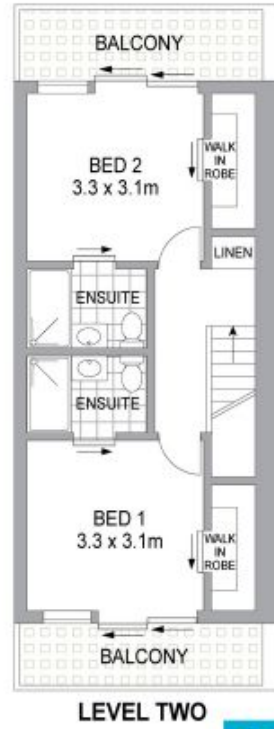
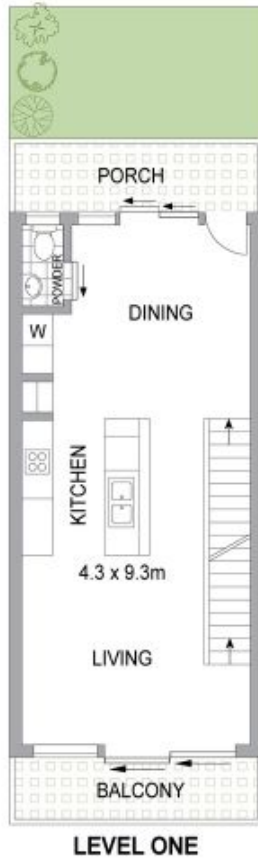

Scale in metres. Indicative only. Dimensions are approximate. All information contained herein is gathered from sources we believe to be reliable. However we cannot guarantee its accuracy and interested persons should rely on their own enquiries.